

TSE 3004 Wireless



Made in Germany
www.burg-waechter.de

Montageanleitung

Assembly instruction

Instructions de montage



2x M4 x 9

4x M4 x 20

6x 2,9 x 13

1x 2,9 x 16

1x 2,9 x 22

2x 3,9 x 22

4x 3,9 x 12

1x 2,9 x 9,5

4x M2 x 10

1x M5 x 80

Innenseite der Tür!
Inside the door!
Côté intérieur de la porte!

Aussenseite der Tür!
Outside the door!
Côté extérieur de la porte!

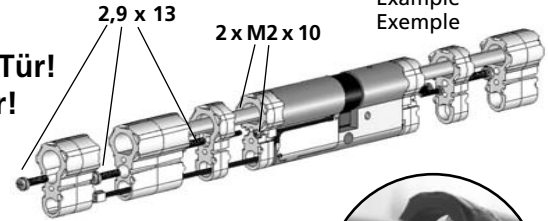
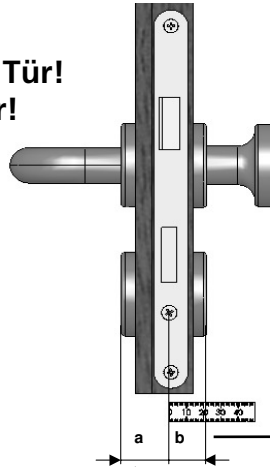

Beispiel
Example
Exemple

4	3	2	1	a
28mm	18mm	8mm	9mm	(mm)
			X	17 - 25
			X	26 - 33
		X	X	34 - 43
	X		X	44 - 53
X			X	54 - 62
X		X	X	63 - 65

b	1	2	3		
(mm)	9mm	8mm	18mm		
17 - 21				X	X
22 - 30	X			X	X
31 - 38	X	X		X	X
39 - 49	X			X	X
50 - 53	X		X		X
54 - 62	X	X			X
63 - 65	X		X		X

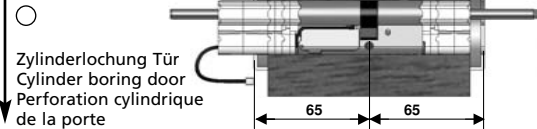

Seite 4,5
page 4,5
page 4,5

Seite 4,6
page 4,6
page 4,6

Seite 4,7
page 4,7
page 4,7

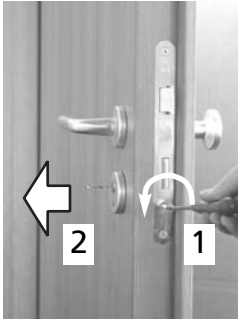

Innenseite
der Tür!
Inside the
door!
Côté
intérieur de
la porte!



Aussenseite
der Tür!
Outside the
door!
Côté extérieur
de la porte!



Funktionstest
Function test
Test de fonctions



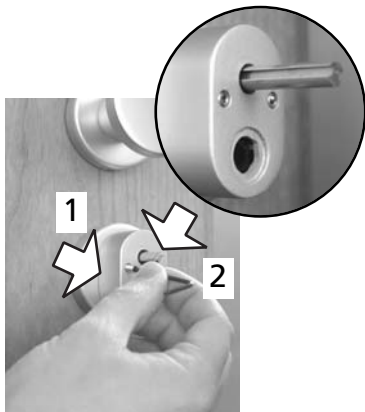



2 x  M4x20



 M4 x 9





  2,9 x 16
oder/or/ou
x 22

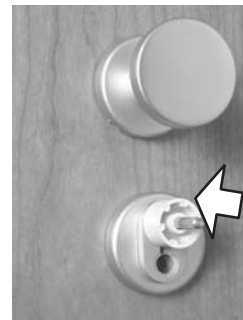

  M4 x 9



OK

→ Seite 8 page 8 page 8

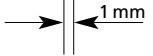
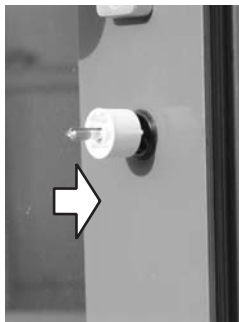
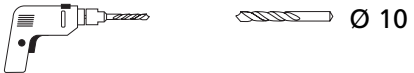
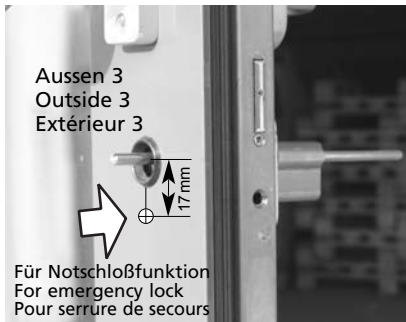

Innenseite
der Tür!
Inside the
door!
Côté
intérieur de
la porte!

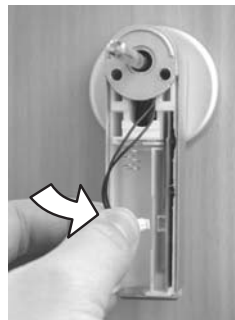



2x 1,5V AA

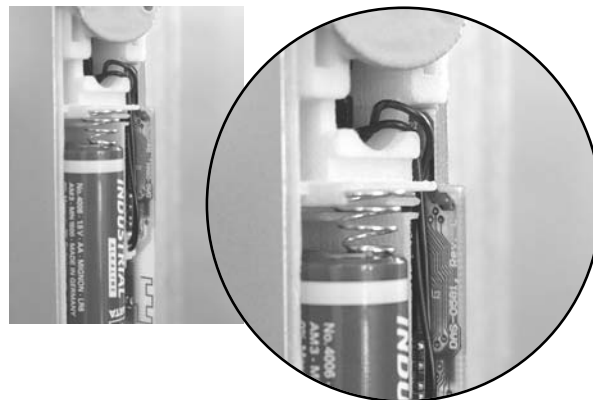



 2,9x9,5







 2xM4x20



 M4x9



OK



oder/or/ou

Oberflächen fettfrei
Surfaces free of
grease
Surface exempté
de graisse

4 x  kleben
adhesive
coller



4 x  Ø 2,9

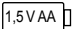

2 x 





BURG-WÄCHTER KG

Altenhofer Weg 15
D - 58300 Wetter
Germany

www.burg-waechter.de
info@burg-waechter.de

TSE 3004 Wireless
Montageanleitung



Irrtum und Änderungen vorbehalten
Omissions and changes reserved
Sous réserve de fautes d'erreurs et
de modifications